

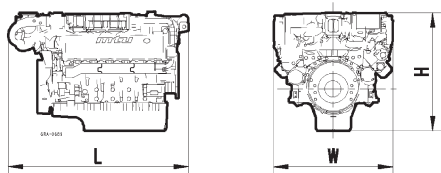

## Oil & Gas

# DIESEL ENGINE 10V 1600

for oil and gas applications  
with EPA tier 4 certification

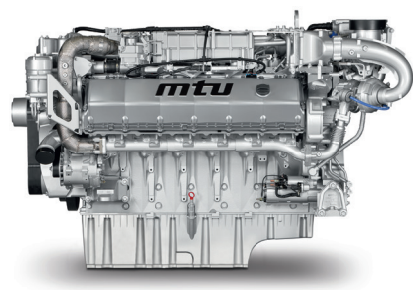

Optional equipment and finishing shown. Standard may vary.

Engine	Dimensions (LxWxH) mm (in)	Mass, dry kg (lbs)
10V 1600 C	1707x 1258 x 1200 (67.2 x 49.5 x 47.2)	1940 (4277) <sup>1)</sup>

All dimensions are approximate, for complete information refer to the installation drawing.

1) DIN 70020

Engine		
Bore/stroke	mm (in)	122/150 (4.8/5.9)
Cylinder configuration		10 V
Displacement,	l (cu in)	1.75 (107)
Displacement, total	l (cu in)	17.5 (1077)
Fuel specification		DIN EN 590, ASTM D975 (DF1, DF2)

Engine type	Rated power			Peak torque			Fuel consumption at rated power	Fuel consumption at peak torque
	kW	bhp	rpm	Nm	lb-ft	rpm	g/kWh	g/kWh
10V 1600 C60	567	760	2100	3385	2497	1200	206	198
10V 1600 C70	613	822	2100	3517	2594	1300	206	198

Exhaust emission: - US EPA Nonroad Tier 4 final (40 CFR 1039)  
- EU Nonroad Stage IV  
- Emission optimized without certificate

Also available for non regulated markets. For information please contact your MTU distributor.

Application	Power definition	
4B	Continuous operation – variable load	Load factor: < 60%, Operating hours: unrestricted, Overload: Fuel stop (ICFN)

Power output within 5% tolerance at standard conditions. Power definition according to ISO 3046 (ratings also correspond to SAE J 1995 and SAE J 1349 standard conditions)

Standard Equipment	Optional Equipment
Common rail injection system	24 Volt alternator, 55 - 200 A
Electronic engine management	Exhaust brake system
Two stage turbo charging with low temperature charge air cooling circuits	Fuel prefilter
2nd coolant water pump for low temperature charge air cooling circuit	PTO drives for hydrostatic pumps (SAE A and SAE B)
High pressure EGR system with high temperature cooling circuit	AC compressor
Engine mounted charge air and EGR coolers	Coupling for main PTO
24 Volt starter	Resilient engine mountings
28 Volt alternator, 80 A	Air compressor
SAE 1 flywheel housing	Elevated fan drive
Mounting brackets	Cooling fan
Close crankcase ventilation	

Reference conditions:

- > Intake temperature: 25°C (77°F)
- > Charge air temperature at 50°C coolant temp.: 45°C
- > Ambient air pressure: 1000 mbar
- > Altitude above sea level: 100 m (328 ft)

Subject to change without notice. Customization possible. Engines illustrated in this document may feature options not fitted as standard to standard engine.